

Installation instructions

MULTIFLEX M



1 – DESCRIPTION

Multiflex M is an area elastic flooring compliant with EN 14904 norm and composed of:

- (1) Multi-layer sports floor 3 strips / 2-Lock (14mm)
- (2) Targlue
- (3) Tarflex (9mm)
- (4) Tarfoam 60 (15mm)
- (5) Tarfilm 200 μ



2 – PACKAGING

Tarfilm : roll of 120m² (3m width x 40m length)

Tarfoam : Roll of 40m² (1.6m width x 25m length)

Tarflex : 1 pack of 8 units - 6.05m² (310mm width x 2440mm length)

Targlue : 1 cardboard of 20 bags of 600ml each - 1 cardboard for 200m²

Wooden boards : 14mm 6 slats/pack - 2.66m² (194mm width X 2281mm length)

PREFACE

In order to provide the customer with the best use of product, this installation guide has to be followed carefully to guarantee conformity and ensure sports performance. If not, Tarkett Sports will not be responsible for damages following installation.

Any use of the product for purposes other than the ones set out, in the condition of use, should be submitted to Tarkett Sports for prior approval. If you need any further information, please contact your dealer who will provide you with the appropriate advice.



Check before installation, the quality of the delivered product. If the product is defective, contact Tarkett Sports. If installation is in process, it shall be stopped on the day the defect is noticed otherwise the Warranty shall not apply.

Multiflex M is a wooden system and as a natural and living material, wood is moving due to relative humidity (RH). The wood shrinks in dry conditions and it expands in high relative humidity. In areas where the wood has been influenced by high or low RH for a longer period, damage in the wood may arise. Therefore it is important to always keep the RH in the hall between 40-60%.

SUBFLOOR

The subfloor must be dry, flat, clean, strong.

The moisture rate for concrete or cement screed must be in accordance with the local requirements.

For example : France ≤ 4%, Germany < 2%, Spain ≤ 3%, (CCM method),...



Subfloor	Requirements
Surface appearance	Smooth
Flatness	≤ 6mm under 3m ruler
Altimetry	+/- 1cm compared to the average
Moister rates for concrete	Local standard compliant
Moister rates for anhydrite screed	< 0,5%
Saw joints treatment	No
Cracks < 1mm treatment	No

Levelling compound is necessary if the surface appearance is not smooth or if the flatness is not compliant.

If the concrete is exposed to capillary moisture surges, it's necessary to waterproof the subfloor by an epoxy resin (or equivalent) before applying the levelling compound, or for localized concrete repair, use a specific moisture-resistant levelling.

INSTALLATION

1 – GENERAL CONDITIONS



The timber products have to be stored on their respective palettes, in a closed, dry and heated room between 15 and 20°C (59 °F and 68°F).

The relative humidity must always be maintained between 40 and 60%.

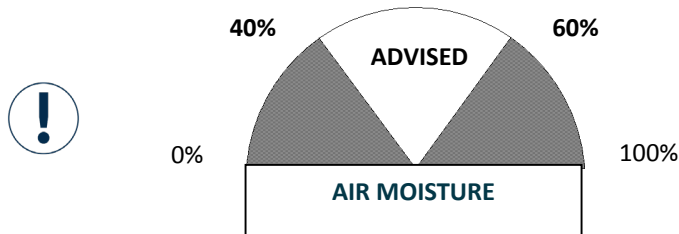

The packages of timber products must not be opened before being installed. Timber products must be acclimatized in the hall for 24 hours before installation.

During installation, the temperature needed, in a room for a Reflex M Evolution system should be between 15 and 20°C (between 59 °F and 68°F).

2 – TARFILM (VAPOUR BARRIER)

Lay the first sheet on the ground. The second sheet is laid with 20cm overlapping the first, then tape the both sheets together. We recommend to use strong adhesive tapes PVC. Do not forget to leave 10cm of Tarfilm along the edges against the walls. Ref. 1027006 (1 roll = 3m width x 40m length = 120sqm, thickness 200µ).

Please note that on an asphalt screed or any other sub-floor with a risk of pollution or possible high humidity content, you will have to double the layers but in a 90° direction.

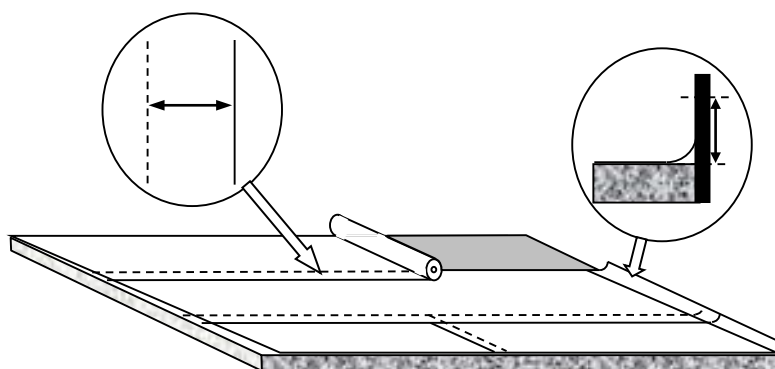

INSTALLATION

3 – TARFOAM 15 mm

Roll out the Tarfoam réf.1027008 alongside the area or across the width of the hall.

The Tarfoam must be unrolling in the width of the room, for those that are less or equal to 25 m width, in order to avoid seams in short ends.

When you lay the foam you may have to cut a roll and to connect it with another, so you will have to overlap the first roll with an extra width of 10cm.

Then the foam will have to rest 12 hours to adapt (without any storage on it), then you will be able to cut off the extra overlapping to get a flat aspect.

In order to lock up the rolls in the short ends, we recommend taping the rolls one to another.

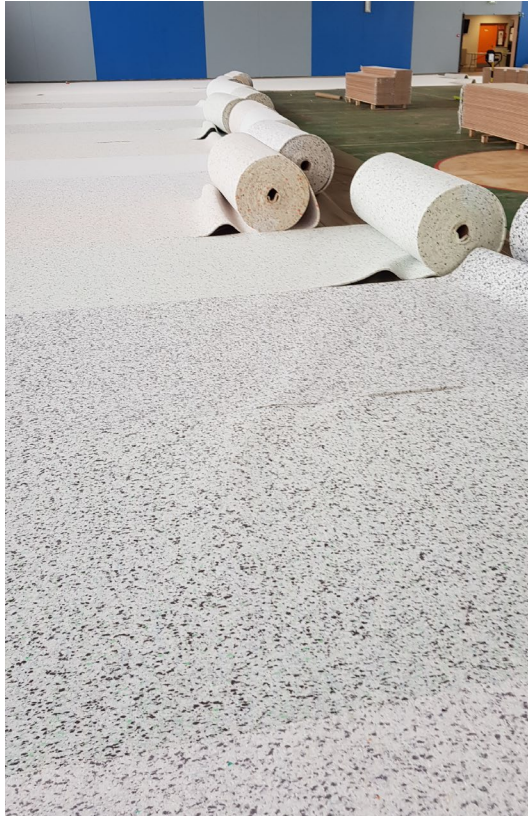
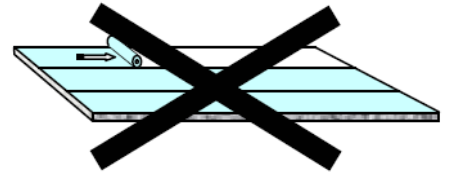
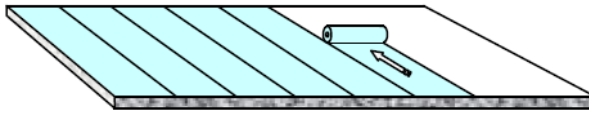

We recommend to use strong adhesive tapes PVC or the Tarkotape.

Do not forget to locate the center of the anchors on the foam, that will help you to install the trapdoors.

At doorways and entrance openings, leave a 10cm wide strip free of Tarfoam; this should be filled with a 14 mm plywood for re-enforcement purposes. The same operation can be carried out to re-enforce parts that support heavy loads but you must keep in mind that these areas won't be in accordance with the EN14904 standard.

INSTALLATION

4 – TARFLEX PANELS

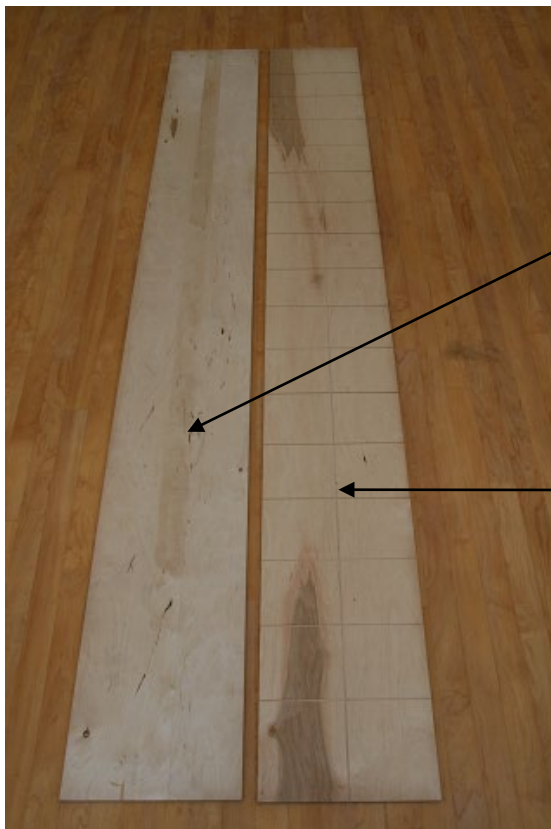

Adhesive will be applied in the groove on Top side of the Tarflex panel.

Backside of the Tarflex panel, this side must be installed towards the foam.



The Tarflex panels réf.1026004 have to be laid from the wall at an angle of 45°. You must leave a gap – 5 to 10mm – between the panels. Do not forget to locate the center of the anchor on the Tarflex panels.



INSTALLATION

4 – TARFLEX PANELS

The expansion gap – all around the installation area should be at least 30mm.

The calculation method is:

Length: $0,10\% \times \text{length}$

Width: $0,15\% \times \text{width}$

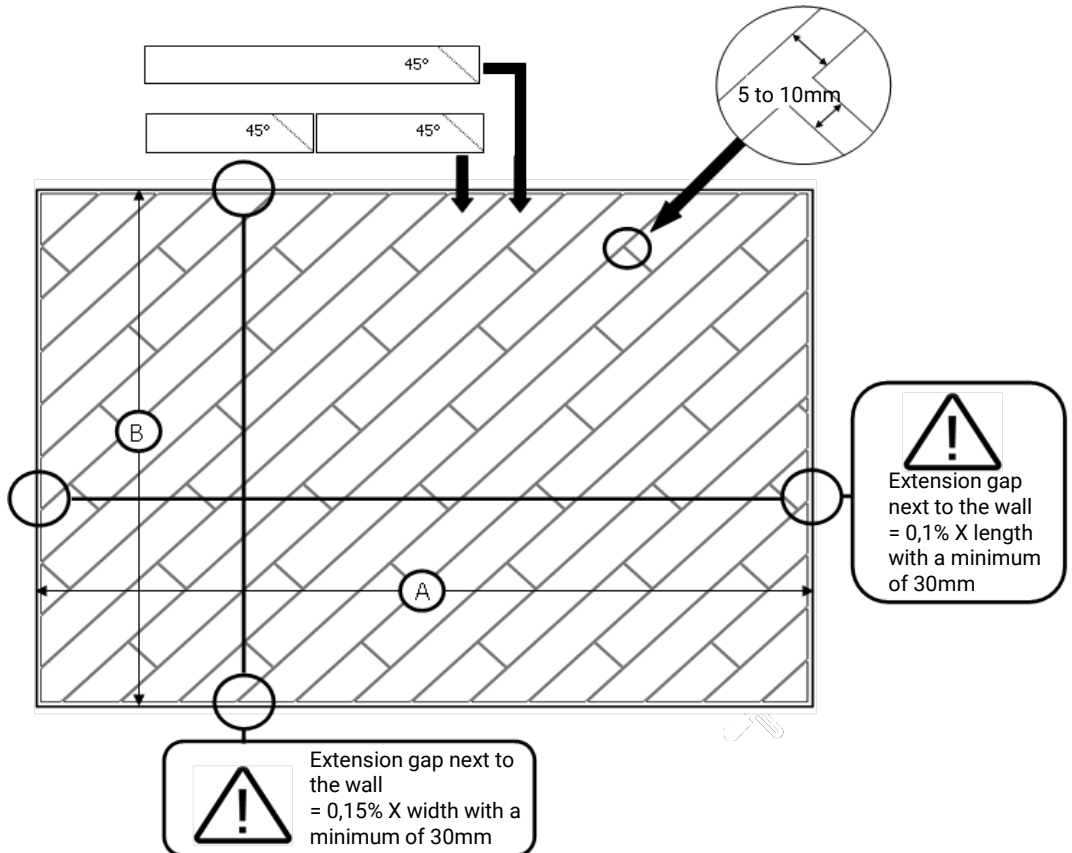

If we consider a 44 x 24m gymnasium

- $44000 \text{ mm} \times 0,1\% = 44 \text{ mm}$ along the wall lengthwise
- $24000 \text{ mm} \times 0,15\% = 36 \text{ mm}$ along the walls widthwise.



The Tarflex Panels must be staggered every row, to start against the wall, always lay a complete panel board between two half panels.

INSTALLATION

5 – 14mm WOODEN PLANK 2-LOCK

In the Tarflex panel, there is a re-cut groove that will be filled with the targlue. Apply the Targlue réf.1551006 by using glue gun (Targun réf.1551007), with 1 bag you can make 11sqm, so with a cardboard you can lay 220sqm.

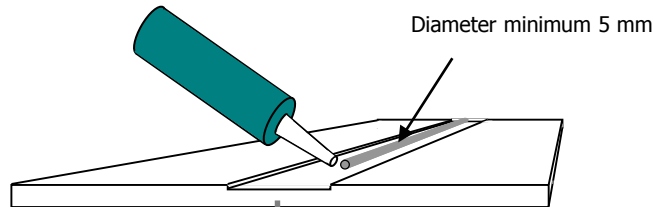

Do not forget to apply several glue spots all around the area, along the walls.

The glue has to be applied by zones, as shown above, just before laying down the 14mm multilayer, the open time for application of the glue is 10 minutes at a 20°C temperature.

2-Lock boards installation :

The 2-Lock system is an ingenious system, and it doesn't need any taping. For the locking of the short wedge, you must exercise a slight press pressure on the short wedge to clip it.

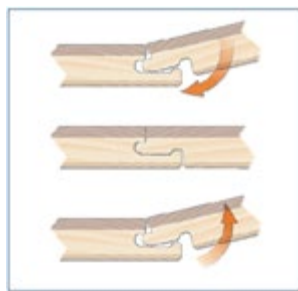

Long side

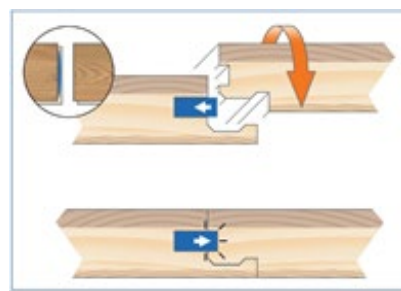

Short end

INSTALLATION

5 – 14mm WOODEN PLANKS 2-LOCK

For an easy installation follow carefully the recommended instructions.

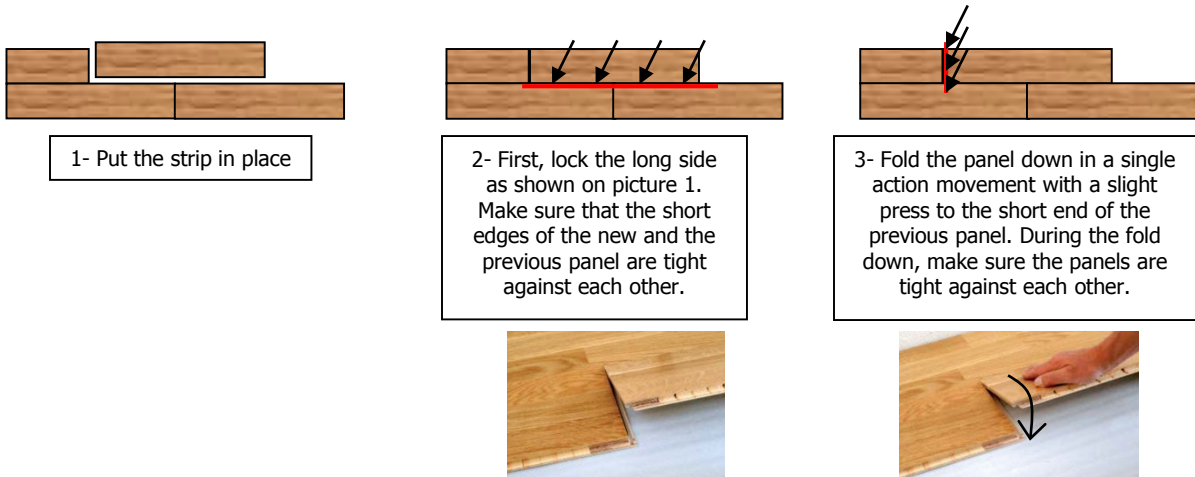

Advice: 50cm a least between the short ends in 2 adjacent rows

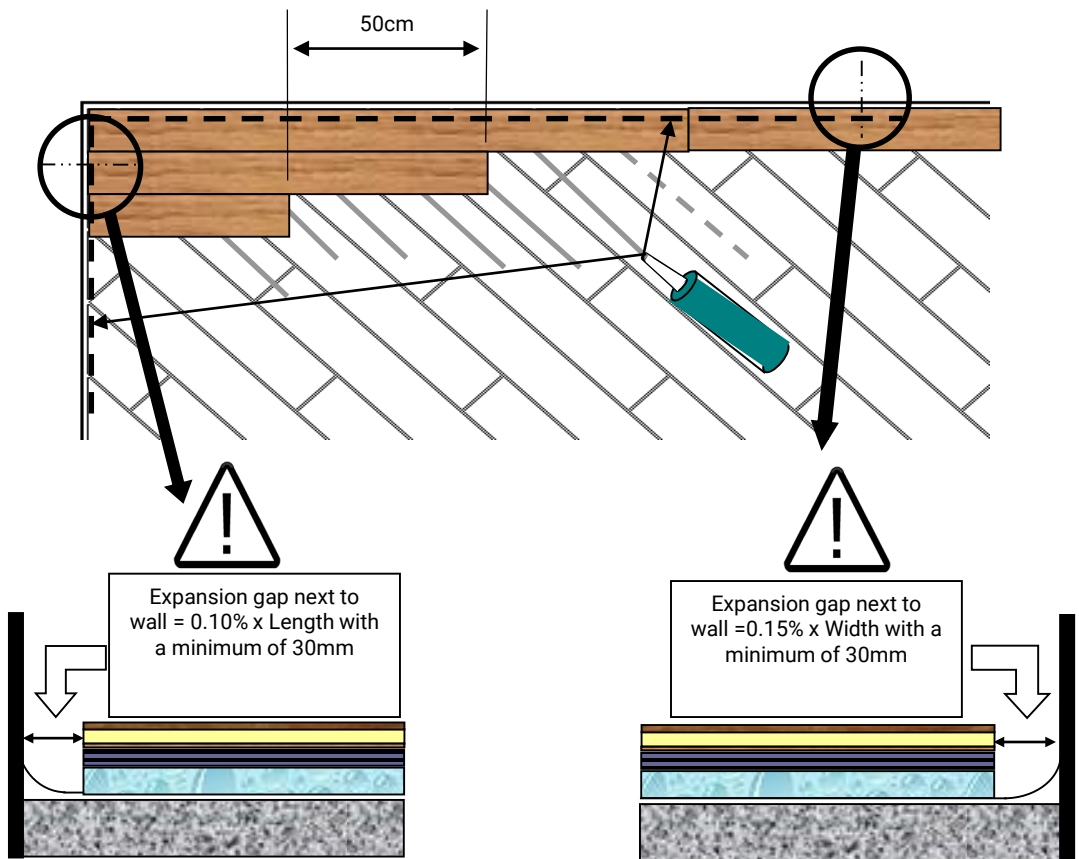

Do not forget to apply several glue spots all around the area, along the walls.

INSTALLATION



6 – TRAP DOORS

Install the trap door :

When installing the Tarfoam and the Tarflex panels, locate the center of the anchor, form a circular recess according to the diameter of the chosen trap door, check the diameter and the depth of each part of the trap door, before perforating the wooden floor. Use a jig saw and a hand-held router.



Before laying the top layer - Apply glue all around the recess you have created



After having laid the top layer - locate the center of the anchor

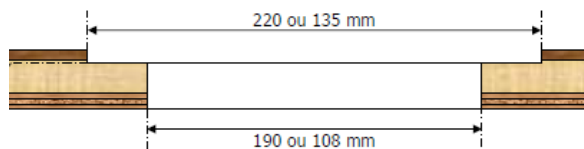

INSTALLATION

6 – TRAP DOOR

Fix the trap door :

Put the PU mastic all around the upper recess you created.

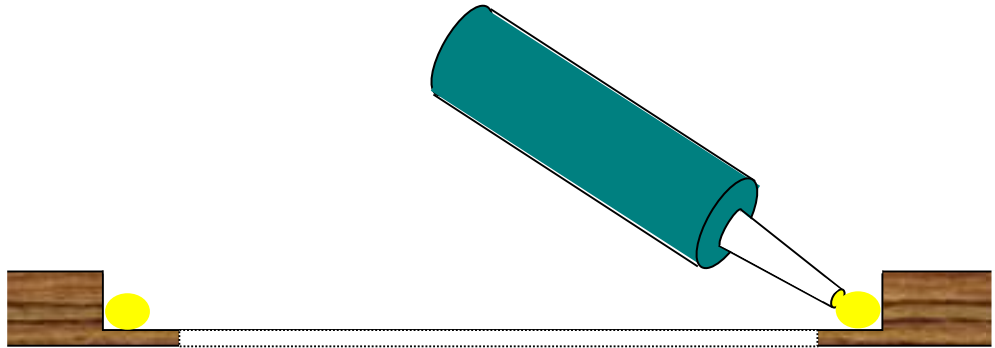

Clean the frame carefully with acetone and place the trap door in the hole.

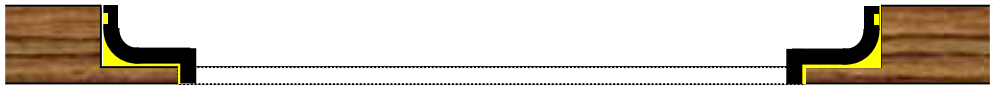

INSTALLATION

8 – SKIRTING

Install skirting :

Ventilated wooden skirting are designed to cover expansion gap and allow the ventilation of the floor.

Warning: the opening all along the skirting let the air circulate, it will always be placed against the wall.

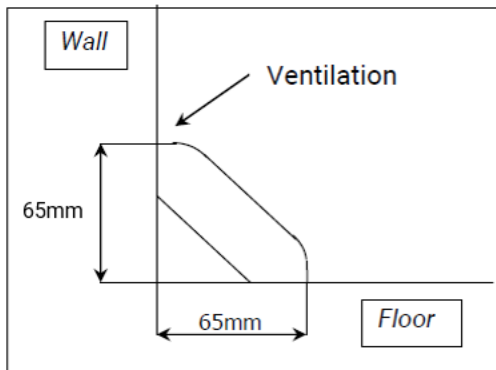

Standard

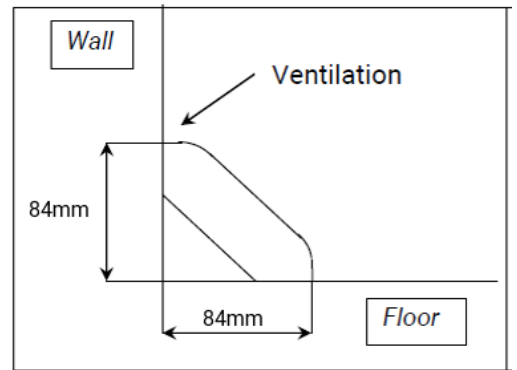

Wide

Fix skirting :

Skirting should be fixed on the wall (never on the floor) with screws (5.0 x 100mm).

For uneven walls skirting can be glued in addition to screws for perfect finishing.

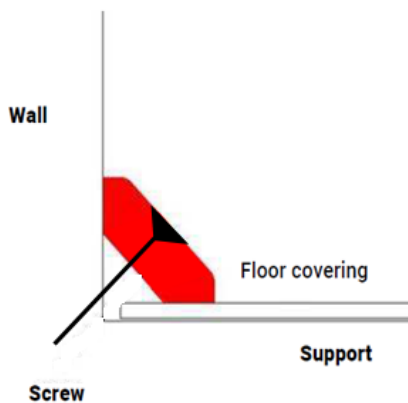

INSTALLATION

9 – GAME LINES MARKING

Permanent marking :

A two-component polyurethane paint is used to draw game lines.

A protective tape is used during the painting to fix the shape.

The floor must be cleaned.

The paint is applied with roller or paint brush.

Two coats should be applied for quality marking; avoiding applying a damp coat on top of a damp coat (the first coat should be dry by touch). Similarly, the covering power of a game line is obtained by applying two coats. Too much paint can cause micro cracking on the surface.

Paints recommended by Tarkett Sports :

- Blanchon Thixo Tracé – Blanchon SA – Tel: +33 4 72 89 06 00
www.blanchon.com
- Kipp 2K PUR Indoor for lines marking and Kipp 2K PUR Surface Paint for the surfaces
www.kipp-markierungen.de
- Bona SuperSport Line Paint – Bona – Tel: +4640385500 - E-mail: bona@bona.com
www.bona.com

Always follow the manufacturer's installation recommendations.

